

GENERAL PROCEDURES

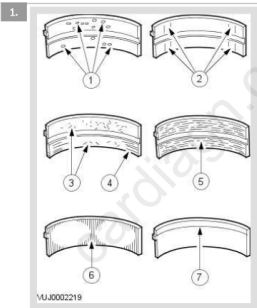

Inspect bearings for the following defects.

1. Cratering - fatigue failure
2. Spot polishing - incorrect seating.
3. Imbedded dirt engine oil.
4. Scratching - dirty engine oil.
5. Base exposed - poor lubrication.
6. Both edges worn - journal damaged.
7. One edge worn - journal tapered or bearing not seated.

GENERAL PROCEDURES

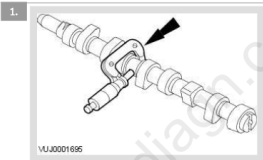

Determine the diameter of the camshaft journals.

Using a micrometer measure the diameter at 90 degrees intervals to determine if the journals are out-of-round.

Measure at two different points on the journal to determine if there is any tapering.

If the measurements are out of the specified range, install a new camshaft.

GENERAL PROCEDURES

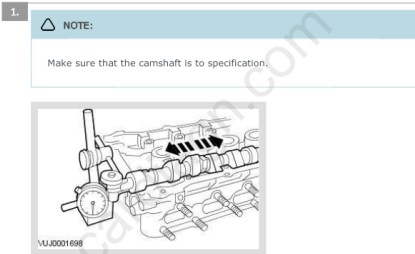

Using the special tool, measure the end play.

Slide the camshaft in both directions. Read and note the maximum and minimum values on the dial indicator gauge.

End play = maximum value minus minimum value.

If the measurement is out of specification, install new components.